

**IMRITA**  
WHOLE HOUSE WATER FILTRATION SYSTEM

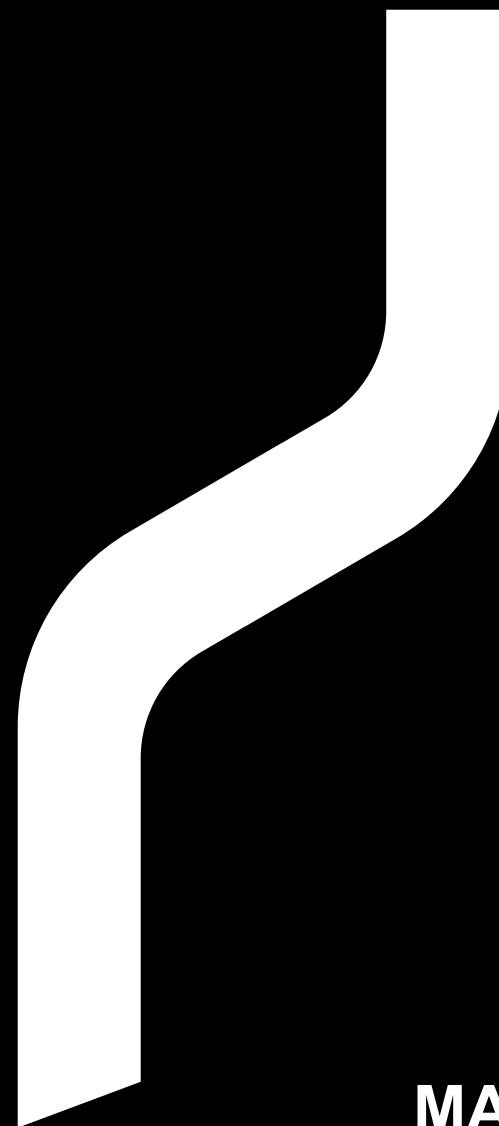

**MANUAL**  
**IMT-G3**

**SHENZHEN IMRITA TECHNOLOGY CO., LTD**  
ADD: 301,302,401,402,501,502, Building B4a, Yingzhan  
Industrial Park, Longtian Community, Kengzi Subdistrict,  
Pingshan New District, Shenzhen.  
Tel: +86-0755-8966-9886 | Web: [www.imrita.com](http://www.imrita.com)

MADE IN CHINA

## THANKS

Thanks very much for choosing IMRITA brand, and be the user of IMRITA.

Before the machine installation, we suggest you to read this manual carefully.

If you have any questions during use, please read this manual carefully or contact us directly.

Email: [export10@imrita.com](mailto:export10@imrita.com)

Tel: +86 0755 89669886

Fax: +86 0755 8966 9907

Your valuable comments on our products and services are most welcome.

## TABLE OF CONTENTS

<b>Safety Precautions</b> .....	1
<b>The Principle Of Performance</b> .....	2
Structure Diagrams.....	2
Electrical Diagrams.....	2
Product parameters.....	2
<b>The principle of performance</b> .....	3
Structure Diagrams.....	3
Installation Steps.....	3
<b>Usage &amp; maintenance</b> .....	4
Use Instruction.....	4
Cleaning.....	4
Malfunctions And Handling.....	5
<b>Packing list</b> .....	6

## SAFETY PRECAUTIONS

### **Warning**

- 1.For personal and property safety, please follow the safety information in this manual. Do not operate the machine without reading it. Otherwise, there maybe occur some problems.
- 2.The power socket must withstand the current larger than the specified value of the machine and reliable grounding measures, and installed leakage protection, otherwise may cause fire accident.
- 3.Do not disassemble, maintain and repair the product by yourself, and do not refit the product without permission, otherwise it is easy to cause security incidents such as water leakage and electricity leakage.
- 4.It is strictly prohibited to turn the machine upside down after power-on. It is strictly prohibited to turn the machine upside down when there is water inside.
- 5.If the power cord is damaged, it must be replaced by a professional from the retailer,manufacturer, its maintenance department, or similar department to avoid any danger.

### **Caution**

- 1.Please use in the room temperature 5-38°C, humidity ≤90% place.
  - 2.The installation position should be away from direct sunlight to avoid leakage caused by aging of the pipeline.
  - 3.Do not pull the power plug by pulling the power line.
  - 4.The water inlet of the machine must be connected to the water purification system.
  - 5.If the machine has not been used for a long time (more than three days), please cut off the power,water supply and drain the remaining water in the machine; Please clean it before use.
- Please immediately turn off the power switch,and the water source, completely discharge the residual water when the machine broke down, and contact the retailer or IMRITA.

## THE PRINCIPLE OF PERFORMANCE

### Structure Diagrams

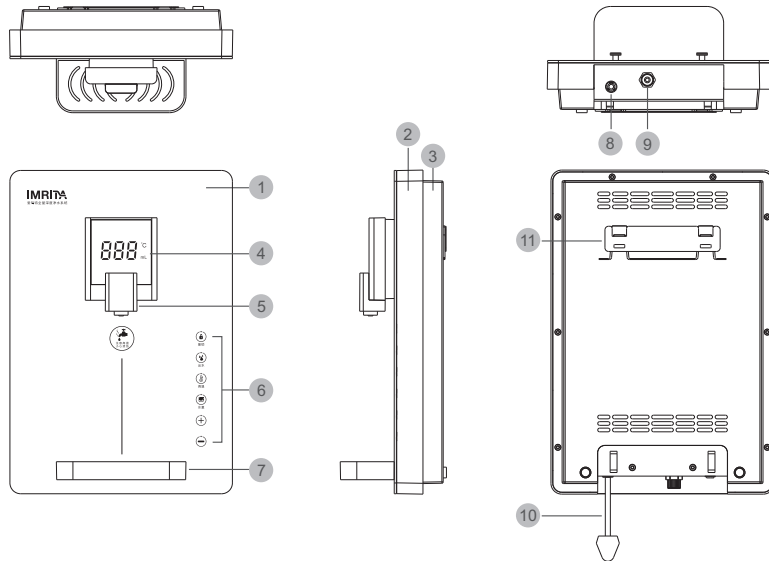

Pic. 1 structure diagrams

- ① Toughened glass panel    ② Front cover    ③ Back cover    ④ LED display screen
- ⑤ Spout    ⑥ Press key area    ⑦ Tray    ⑧ Water inlet
- ⑨ Drain outlet    ⑩ Power line    ⑪ Mounting plate

### Electrical Diagrams

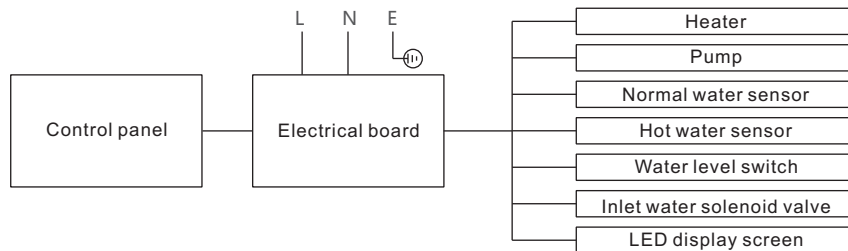

Pic. 2 electrical diagram

### Product parameters

Product name: Instant Water Dispenser	Item No.: IMT-G3
Voltage/Frequency: 220V-50Hz	Heating Power: 2100W
Rated Power: 2100W	Anti Electric Shock Type: I
Standby power consumption: ≤0.05kW.h/24h	Temperature: 5-38°C
Humidity: ≤90%	Heating capacity: ≥20L/h
Product Size: 450x310x147mm	

## THE PRINCIPLE OF PERFORMANCE

### Structure Diagrams

- It should be installed by a professional worker; Please check whether the accessories are complete and machine is normal before installation.
- The machine should not be installed outdoors, and should be far away from ultraviolet light, heat source, fuel oil and various chemicals.
- All the pipes, fittings, faucets and other wading accessories should meet the national health standards.
- Please check carefully whether there is water leakage or seepage at each fittings or joints after installation.

### Installation Steps

- Open the package, take out the machine and the attached mounting plate, and fix the mounting plate in horizontal position;
- Hang the machine vertically on the mounting plate; After the machine is hung and confirmed that the hanging plate is fixed horizontally, fix the machine to the right position on the mounting plate, and confirm that the machine is placed vertically.
- Use 1/4" PE tubing connect the water purifier system with the machine;

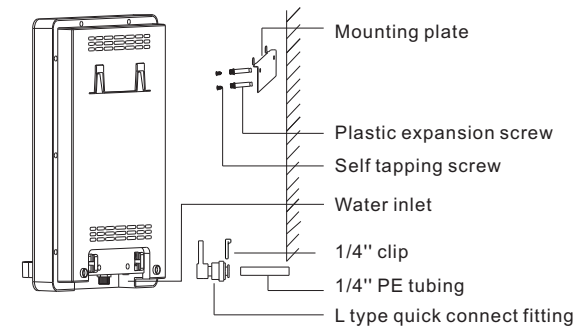

Pic. 3 Installation diagram

## USAGE & MAINTENANCE

### Use Instruction

1. Connect with the power supply, the LED display screen lights up, the water will come into the machine automatically.
  2. Place a bottle or a cup under the spout of the machine, press the function key area to start work.
  3. Suggest to washing the heater for 2-3 times when first use.
  4. Function key instruction:
    - 1) LOCK "🔒": Press 3 seconds, lights off shows being unlocked, lights on shows being locked. It will automatically lock when there is no operation within 15 seconds; Long press the LOCK for 10 seconds can permanently remove the child lock state, and long press the LOCK key for 10 seconds can restore the child lock state.
    - 2) WATER "💧": press "💧" key for water and then press it again to stop it. It lights up when in work status, and will off when in standby status.
    - 3) TEMP "🌡️": press "🌡️" to choose the temperature, there are five temperature for option: normal water, 45°C, 65°C, 85°C, 100°C, the system default is normal water when first use. The touch button indicator is constant on in working mode and off in standby mode.
    - 4) Volume "📏": press "📏" to choose the water volume, there are five volume for option: 150ml, 230ml, 300ml, 500ml, unlimited (1L, the display shows 999ml), the system default is 230ml; The touch button indicator is constant on in working mode and off in standby mode.
    - 5) "+/-": 45°C (45°C-64°C), 65°C (65°C-84°C), 85°C, (85°C-99°C), the temperature can be adjusted in three intervals: press "+" to increase 1°C, press "-" to decrease 1°C.
    - 6) In the process of discharging water, press any key to stop discharging water.
- Set the boiling point according to different altitudes, and press the "🌡️" and "📏" for 3 seconds to enter the boiling point setting. "+" touch to increase 1°C, "-" touch to decrease 1°C, press the "💧" to save the setting temperature.

### Cleaning

This product is used continuously for three months (depending on the water quality of different places) or unused after long-term disuse, it is recommended to clean the internal waterway.

1. Internal cleaning with proper proportion of edible detergent mixed with purified water.
2. As shown in Figure 4, remove the spout, clean it, and reinstall it.
3. It is recommended to contact professional maintenance personnel of the company's maintenance for cleaning.

.4.

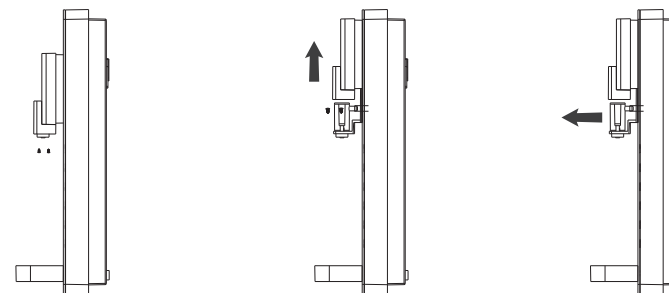

Step.1 unscrew the screws which fixed the cover

Step.2 take out the cover upwards, unscrew the screws which fixed the spout

Pic. 4 spout disassemble diagram

Step.3 pull out the silicon hose, take out the spout

## Malfunctions and Handling

The following table is a list of possible malfunctions and their causes, please refer to their general troubleshooting methods.

Malfunction	Troubleshooting	Handling
E0	Commcardfault	Replace the press key board or main control board
E1	Water shortage alarming	Replug after recover water supply
E2	Water inlet NTC malfunction	Replace the water inlet NTC or main control board
E3	Water outlet NTC malfunction	Replace the water outlet NTC or main control board
E4	Low temperature alarming	Automatic deactivate alarm when water temperature above 1°C
E5	Voltage sensor malfunction or the voltage scope of 160-280V	Replace the main control board or voltage recover to normal
E6	Over heat alarming	Automatic deactivate alarm when heater temperature low down
E7	Ultra temperature alarming	Automatic deactivate alarm when heater temperature low down
E8	Heater malfunction	Replace the heater
E9	PCB malfunction	Replace the main control board
E10	Pump malfunction	Replace the pump or main control board
E11	Scaling malfunction	Remove the scaling

.5.

## PACKING LIST

Instant water dispenser	Stainless steel mounting plate
Manual	1/4" pe tubing
Screw kit	1/4" quick connect fitting
L type 1/4" quick fitting	1/4" clip